

ELECTROMAGNETS

8500 SERIES

The 8500 Series Electromagnets replace 8011 Series while offering the same functionality.

All of the magnets in the range are 12/24 VDC selectable, fail-safe, suitable for indoor use, featuring anti-residual magnetism design and keyhole mounting for ease of installation.



STANDARD FEATURES

- Easy installation with keyhole mounting "slides left to right"
- Mounting hardware included to mount the maglock and the armature plate for out-swinging door
- No residual magnetism
- Fail alarm: may be released upon activation of fire alarm
- Housing: attractive, heavy duty anodized extruded aluminum housing, no need for a cover
- Mounting hardware included with each unit, for out-swinging doors
- Optional brackets for in-swinging doors and special installations (see Accessories)
- Dual voltage 12/24 VDC field selectable
- Fail-safe: releases instantly when power is disconnected. No residual magnetism

SPECIFICATION

HOLDING FORCE	1200 LB
VOLTAGE	12/24 VDC
CURRENT	500 mA/12 VDC , 250 mA/24 VDC
DIMENSIONS	Magnet: 10 1/2" x 1 9/16" x 2 11/16" Armature Plate: 7 1/4" x 5/8" x 2 3/8"

8500 SERIES MODELS

MODELS	DESCRIPTION
8512-LC	Standard Single Magnet
8512-LC US40	Standard Single Magnet (US40)
8512-B	Standard Single Magnet, Bond Sensor
8512-2-B	Standard Double Magnet, Bond Sensor
8512-2-B-US40	Standard Double Magnet, Bond Sensor (US40)
8512-20993	Oklahoma Special with Specifically Designed PC Board
8512-DE	Standard Single Magnet, Delayed Egress

ATTACHING MAGNET TO MOUNTING PLATE

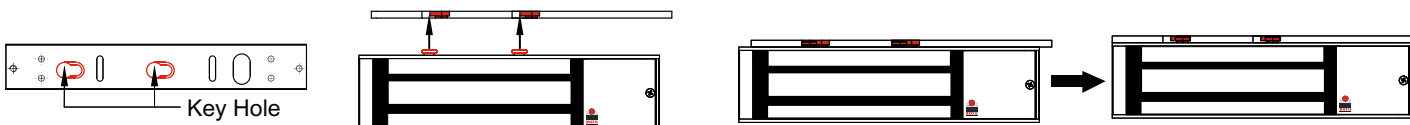

1. Align the two slotted holes and attach the magnet to the mounting plate.

2. Slide the magnet onto the mounting plate.
➔ Keyhole Mounting "slides Left to Right"

ELECTROMAGNETS

ELECTRIC STRIKES

EXIT DEVICES

MISC. ACCESS CONTROL